

# BENDING TYPE LOAD CELL

Rated Load 75 - 125 - 250 kg



automation and engineering



# PVH

## SPECIFICATION

• Sensitivity	mV/V	3 +/- 0.001
• Non-linearity	%FS	+/- 0.02
• Hysteresis	%FS	+/- 0.02
• Creep	%FS	+/- 0.01
• Zero Balance	%FS/30 min	+/- 1
• Zero Temperature Drift	%FS	+/- 0.02
• Rated Output Temperature Drift	%FS/10°C	+/- 0.02
• Input Resistance	%FS/10°C	385 +/- 10
• Output Resistance	$\Omega$	350 +/- 3
• Insulation Resistance	$\Omega$	$\geq 5000$
• Supply Voltage	M $\Omega$	10 max 15
• Compensated Temperature Range	Vac/dc	-10 ÷ +50
• Operating Temperature Range	°C	-20 ÷ +60
• Safe Overload	°C	120
• Ultimate Load	%FS	300
• Cable	%FS	$\varnothing 5$ - L 5000
• Material	mm	Stainless steel
• Cable Color Code		Input: Red (+), Black (-) Sense: Blue (+), Brown or Yellow (-) Output: Green (+), White (-)
• Sealing		IP65 - Resin Potted

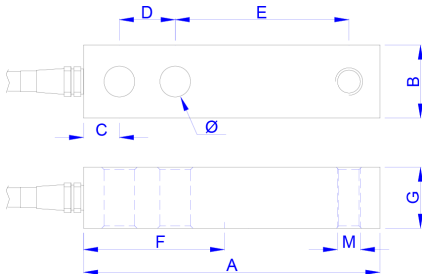

Load (Kg)	Size mm								M
	A	B	C	D	E	F	G	$\varnothing$	
75 - 125 -250	130	32	15,5	25,4	76,2	57	25	13,5	M12x1,75

# SHEAR TYPE LOAD CELL

Rated Load 0,5 - 1 - 2 tons



automation and engineering

## TREE AND FOUR LOAD CELL ARRAGEMENT

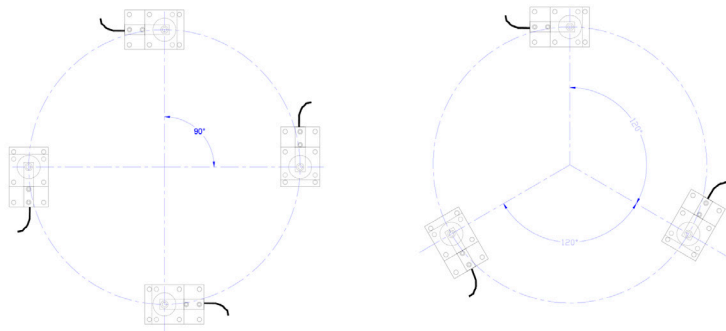

## MOUNTING FOOT MOD. MK-GXP 200

