

SINGLE POINT LOAD CELL

Rated Load 50 to 1000 kG

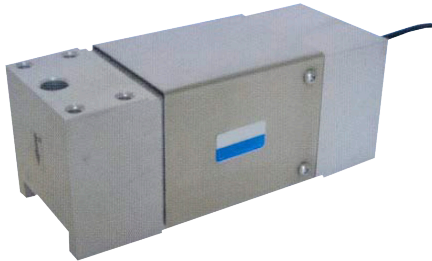

automation and engineering



PE-5

SPECIFICATION

• Sensitivity	mV/V	2 +/- 0.01
• Non-linearity	%FS	+/- 0.02
• Hysteresis	%FS	+/- 0.02
• Repeatability	%FS	+/- 1
• Creep	%FS/30 min	+/- 0.02
• Zero Balance	%FS	+/- 2
• Zero Temperature Drift	%FS/10°C	+/- 0.02
• Rated Output Temperature Drift	%FS/10°C	+/- 0.02
• Input Resistance	Ω	420 +/- 10
• Output Resistance	Ω	350 +/- 3
• Insulation Resistance	M Ω	\geq 5000
• Supply Voltage	Vac/dc	10 max 15
• Compensated Temperature Range	°C	-10 ÷ +50
• Operating Temperature Range	°C	-20 ÷ +60
• Safe Overload	%FS	120
• Cable	mm	\varnothing 5 - L 3000
• Material		Aluminum
• Cable Color Code		Input: Red (+), Black (-) Output: Green (+), White (-)
• Rated Load	Kg	50, 75, 100, 150, 200, 250, 300, 500, 630,
• Sealing		IP65 - Resin Potted

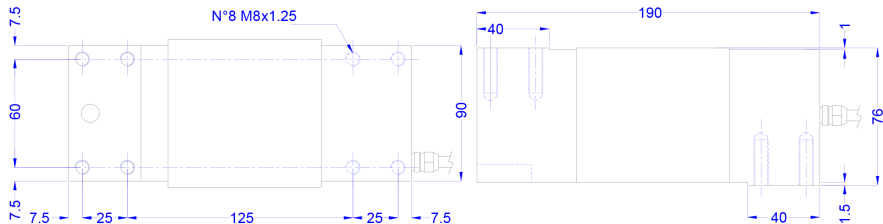

automation and engineering

27020 Travacò Siccomario
Via del Tovo 5/3 Pavia Italy

Tel. +39 0382 482657
Fax +39 0382 1850248

commerciale@logic-pavia.it
www.logic-pavia.it